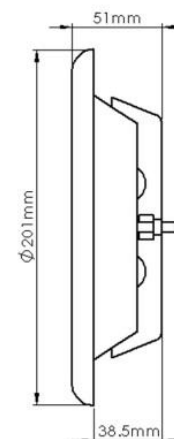
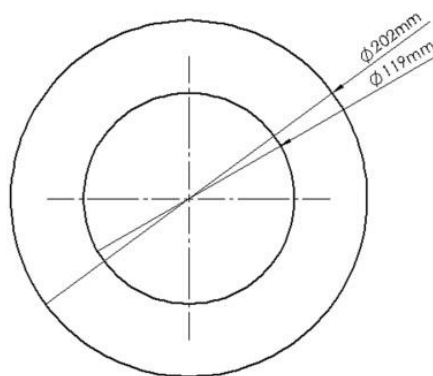

PRODUCT DATA SHEET

MW154

WHITE METAL CEILING AIR EXTRACT VALVE

W RAL9010

SPECIFICATION DETAILS

The MW154 150mm diameter Round White Metal Ceiling Air Extract Valve is manufactured from White Epoxy Powder Coated Steel. The valve has a male spigot to fit inside the System 150 duct.

The MW154 extract air valve is fully adjustable and has a locking nut to fix the position of the controlled disc upon commissioning.

The MW154 is supplied complete with a fixing body with pre-drilled holes for installation.

MW154 has been designed for use with Verplas System 150 Round.

Manufacturer:	Verplas Ltd
Part Number:	MW154
Size:	150mm Diameter
For use with:	Verplas System 150
Box quantity:	7
Individual Weight:	510g
Colour:	White

MAX/MIN OPERATING TEMPERATURES

+ 60°C to - 15°C

PERFORMANCE CURVE

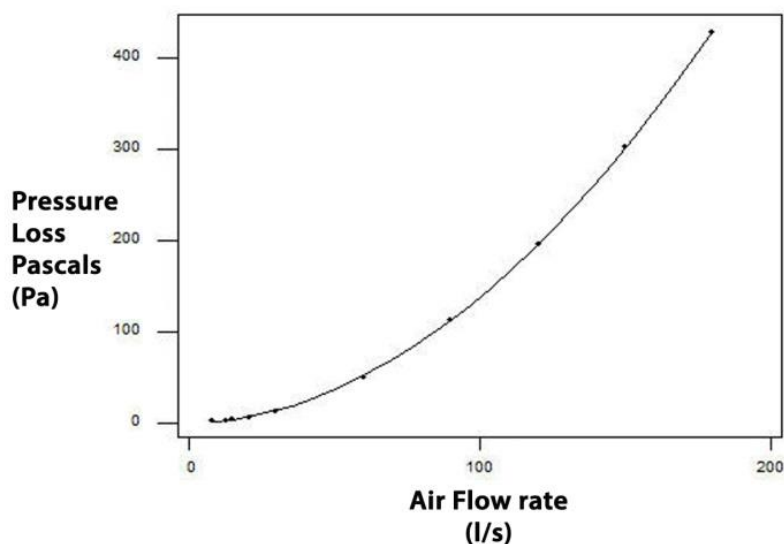

AIRFLOW	RESISTANCE
8 l/s	1.70 pa
13 l/s	2.60 pa
21 l/s	6.00 pa
30 l/s	12.50 pa
60 l/s	49.60 pa
120 l/s	195.20 pa

Associated Ancillaries

150mm 2m Round Pipe



VKC673

150mm Round Pipe Connector



VKC365

150mm Round Wall Plate



VKC661

150mm 90° Elbow Bend Round



VKC360

150mm Equal T Piece Round



VKC362